

Warmline PIR

PIR Bonded to Plasterboard

The Warmline insulated plasterboards are designed as a simple and effective way to improve the thermal efficiency in both walls and roof dwelling applications. They are full applicable with Part L of the building regulations.

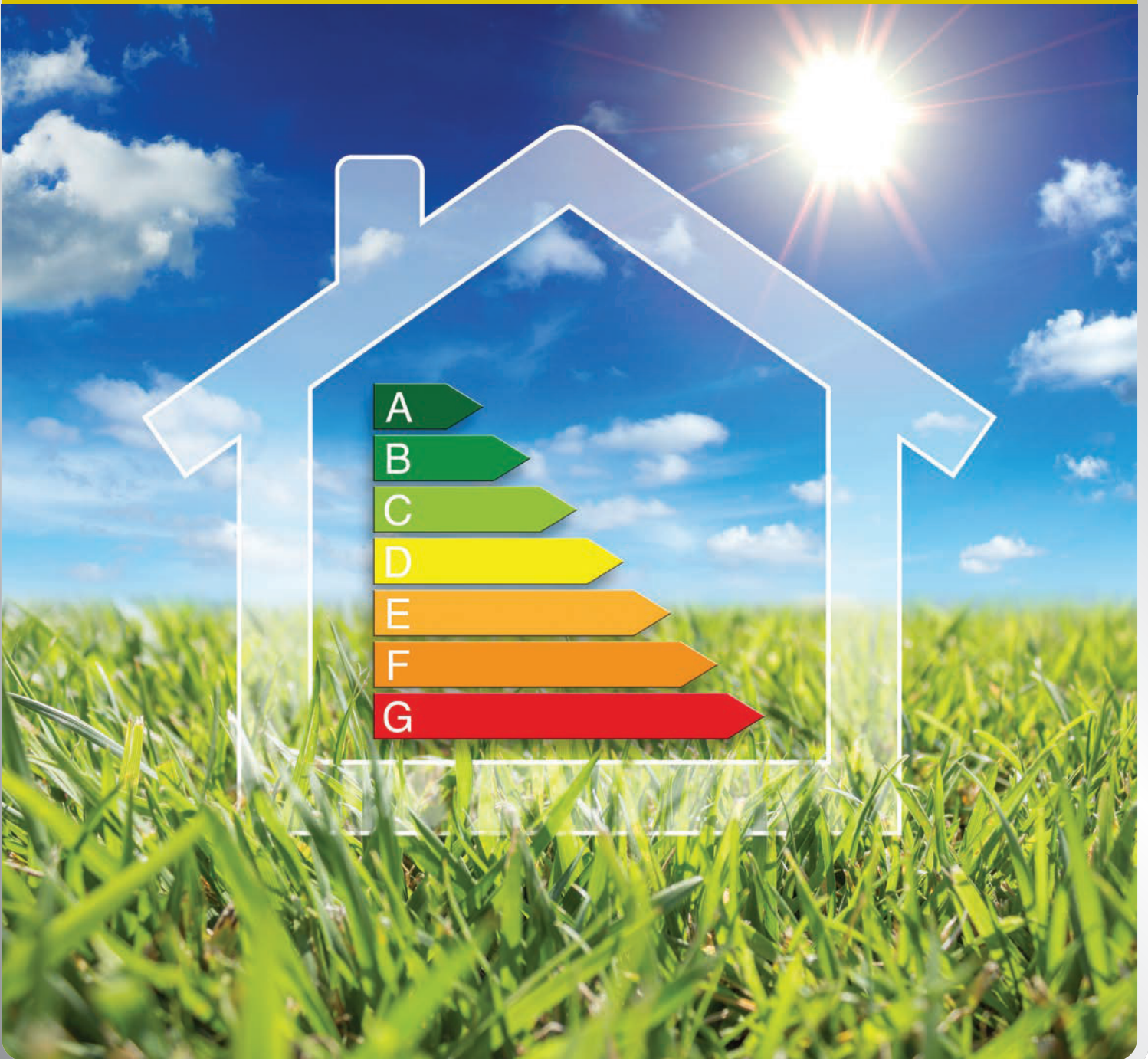



Polyisocyanurate Foam Bonded to Plasterboard Benefits

- All thicknesses readily available
- Simple solution to upgrading walls and roofs
- Quick and easy to install
- Can be used for both newbuild and refurb
- A simple way to meet building regulations
- Cost effective return

Technical Specifications

Product Code	Product Size	m2 Per Board	Description	Overall Thickness	Foam Thickness	Plasterboard Thickness	Boards Per Pallet	Thermal Conductivity (W/mK)	Thermal Resistance (m2k/W)
U/WLP29	1200x2400	2.88	PIR Bonded to Plasterboard	29.5mm	20mm	9.5mm	68	0.022	0.98
U/WLP32	1200x2400	2.88		32.5mm	20mm	12.5mm	62	0.022	1.02
U/WLP38	1200x2400	2.88		37.5mm	25mm	12.5mm	52	0.022	1.21
U/WLP52	1200x2400	2.88		52.5mm	40mm	12.5mm	38	0.022	1.87
U/WLP62	1200x2400	2.88		62.5mm	50mm	12.5mm	32	0.022	2.32
U/WLP72	1200x2400	2.88		72.5mm	60mm	12.5mm	28	0.022	2.77
U/WLP82	1200x2400	2.88		82.5mm	70mm	12.5mm	24	0.022	3.22
U/WLP92	1200x2400	2.88		92.5mm	80mm	12.5mm	22	0.022	3.71

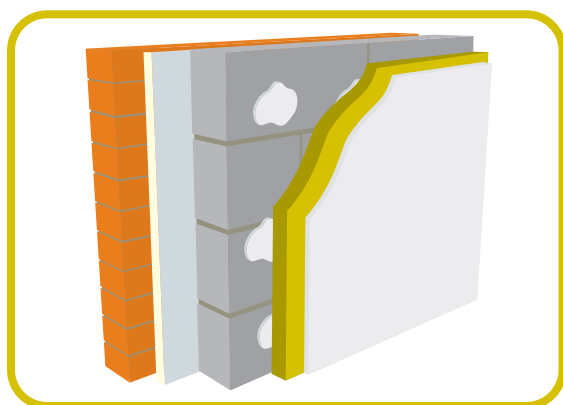

Fixing instructions for Dot and dab

- For bonding Warmline range to a wall use a proprietary gypsum based adhesive.
- Please follow the manufacturers instructions. As per manufacturers recommendations apply a continuous ribbon of adhesive around any openings.
- Apply 3 vertical rows of adhesive dabs to the walls at 300mm centres. Also insure that there is a continuous bead at the bottom and top.
- After the adhesive has set fix a minimum of 2 insulation anchors through the board into the wall. They must go into the masonry by a minimum of 30mm.

Fixing instructions for mechanical fixing

- Fix to the wall treated batons 50mm x 25mm at a maximum of 600mm centres. Also fit horizontal batons at both floor and ceiling level.
- Then fit the warmline board using drywall screws at 150mm centres. Always insure that they penetrate the batons by 25mm.
- When installing boards to rafters fix them at right angles to the timbers. To ensure a solid finish bridging pieces are to used inbetween the rafters.

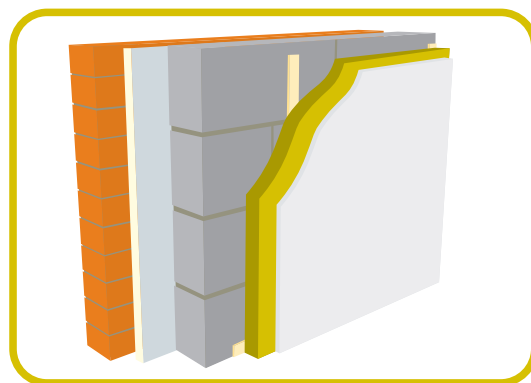

**U Value
Insulation**
Delivering Better Solutions

Insulated Plasterboard Manufacturers & Distributors

For more details you can contact our technical teams:

Unit 3, Broadfield Business Centre Off Pilsworth Road, Heywood, Manchester, OL10 2TA
Unit 24, Trade City Business Park, Cowley Mill Rd, Uxbridge UB8 2DB

Sales: 01706 629793

e-mail: sales@uvalueinsulations.co.uk

